

# Tugboat "BEVER"

## Technical specifications Shoalbuster 2709 "Bever"



### General

Yard	: Damen Shipyards Hardinxveld
Delivery Date	: April 2007
Type of vessel	: Damen Shoalbuster 2709
Class	: B. V. I 3/3 Tug Unrestricted navigation 0
MACH, AUT-UMS	
Nat.Autorities	: IWW regulations for unrestricted navigation
Flag	: Dutch
Owner	: Vieggers & Son Tugboatservices

### Dimensions

Lenth o.a	: 27.19 mtr.
Beam o.a	: 9.10 mtr.
Depth at sides (half length)	: 3.60 mtr.
Draught aft	: 2.70 mtr.
Displacement	: 300 ton

### Tank capacities

Fuel oil	: 136.7 m <sup>3</sup>
Fresh Water	: 30.3 m <sup>3</sup>
Sewage	: 2.1 m <sup>3</sup>
Luboil	: 3.2 m <sup>3</sup>
Hydrolic oil	: 1.6 m <sup>3</sup>
Bilge water	: 3.8 m <sup>3</sup>

### Performances

Bollard Pull	: 40 tons
Speed	: 11 approx.

### Propulsion system

Main engines	: 2 x Caterpillar 3512 B TA/A
Output	: 3000 bhp 2238 kW at 1600 rpm
Gearboxes	: 2 x Reintjes WAF 664L 5.95:1
Propulsion	: 2 x Promarin fixed propeller
Diameter	: 2 x 2100 mm in Optima nozzles
Bowthruster	: 200 bhp hydraulically driven

### Auxiliary Equipment

Generator sets	: 2 x Caterpillar 3056T
Capacity	: 2 x 95 kVA 50 Hz 220/400 V
Hydraulic set	: 1 x Caterpillar C-09 TA 269 kW at 1800 rpm
Emergency hydraulic pump	: Electric driven load sens pump 15 kW 400 V
Transfer pumps	: Fuel 32 m <sup>3</sup> /hr at 1.5 bar : Fresh water 32 m <sup>3</sup> /hr at 1.5 bar
Fresh watermaker	: HEM 6000 ltr/24 hr
Fuel seperator	: Alfa Laval MIB 303 S 1150 liter/hr

### Deck Lay-out

Anchor Handling / Towing winch	: Ridderinkhof waterfall winch
Towingdrum	: 50 ton at 2.5 m/min, slack rope 17.5 m/min, brake force 75 ton
Anchorhandling drum	: 100 ton at 2.0 m/min, slack rope 17.5 m/min, brake force 100 ton
Wire capacity	: Towingwire 750 m dia 40 mm, working wire 500 m dia 40 mm
Deck crane	: Heila HLRM 140-3 SL remote controlled
Capstan	: Ridderinkhof 3 ton 10 m/min
Towing pins	: WK Hydraulic 500 mm triple type
Pushbow	: 900 mm
Stern roller	: diameter 800/1000 mm, length 4000 mm
Salvage pump	: Grindex 3200 liter/min

### Nautical and Communication Equipment

GMDSS	: A4 Equipped
Radar system	: 2 x Furuno FAR-2117
SSB	: Sailor MF/HF SSB transceiver HT 4520 with DSC
VHF radio telephone	: 3 x Sailor RT 5022 with DSC
Inmarsat C	: Sailor H 2095 C
Inmarsat F	: Nera Fleet 77 terminal
Electronic Chart system	: Tsunamis Navigator Pro
GPS	: Furuno GP 90
AIS	: Furuno FA 150
Echosounder	: Furuno NAV 7
Speed log	: Ben Marine Anthea
Intercom	: RZ Sigma 700
Autopilot	: RH seapilot 75
Gyro Compass	: Anschutz
Magnetic compass	: Observator MK IV
CCTV	: Orlaco CC Solo BI/W 2 x 9" monitor units
Watch alarm	: Marble 401 S
Phone / Fax	: Radio Holland

SEACONTRACTORS  
Bellamypark 50-52  
4381 CK Vlissingen  
The Netherlands

Tel: +31 (0)118 410 520  
Fax: +31 (0)118 410 877

Email: [info@seacontractors.com](mailto:info@seacontractors.com)  
Website: [www.seacontractors.com](http://www.seacontractors.com)



# SEACONTRACTORS

Sea Towing - Heavy Lift Shipping - Marine Contracting  
Offshore Brokerage - Personnel Services

# Shoalbuster 2709 "Bever"

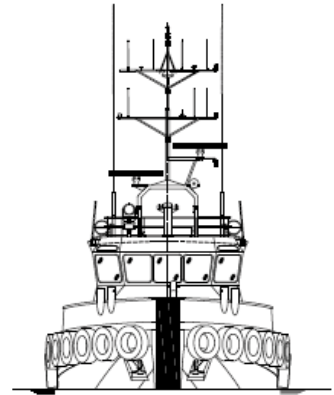
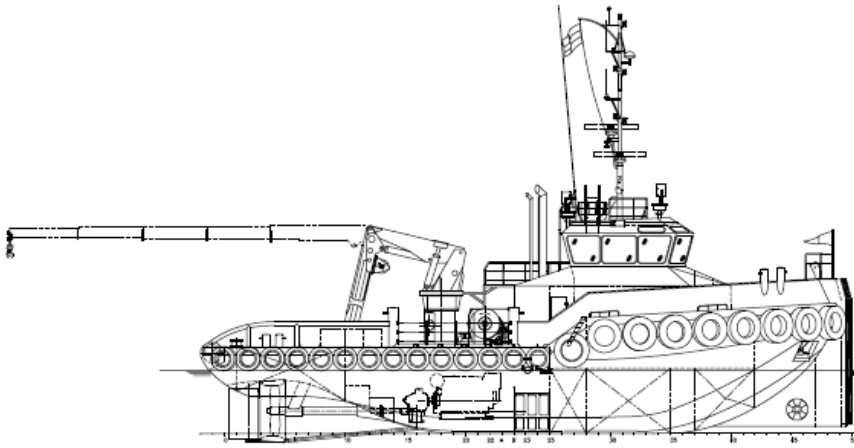

Forecastledeck

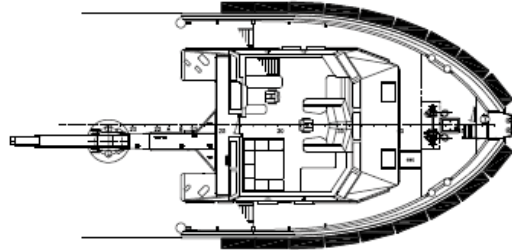

Topdeck

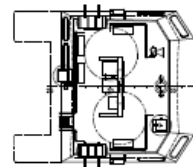

Maindeck

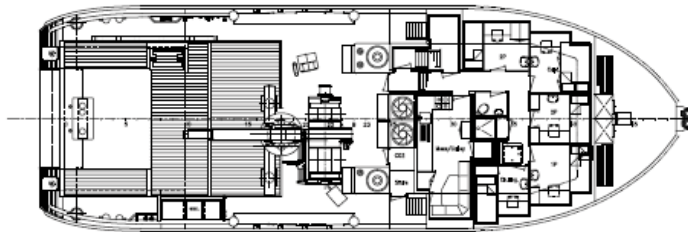

Below maindeck

